

SERVICE PROGRAM



SP 3-144-004

November, 2008

**ATTENTION: SERVICE MANAGERS/
PARTS MANAGERS**

**SUBJECT: REPLACE INSTRUMENT
CLUSTER LIGHT BAR**

**VEHICLES AFFECTED: AUTOCAR ACX MODEL
VEHICLES BUILT BETWEEN 30
NOVEMBER 2007 AND
22 SEPTEMBER 2008, VIN
RANGE 206686 TO 208559**

**PROGRAM
EXPIRES: 17 NOVEMBER 2009**

Service Program Information:

The instrument cluster light bar in certain Autocar ACX heavy duty class 8 vehicles has a software programming error which incorrectly causes the ABS trailer light to illuminate and stay illuminated. This program describes the procedure for replacing the light bar with the faulty programming.

Vehicles Affected:

There are 321 affected vehicles that were manufactured between 30 November 2007 and 22 September 2008, within VIN range 206686 to 208559. Refer to VIN list beginning on *page 3*.

NOTE: To determine whether a particular vehicle is affected by this service program (or any other service program), consult the Service & Warranty link on Autocar's website: www.autocartruck.com. After logging into the dealer section of the website, enter the VIN into the VIN Profile; the system will display any outstanding service programs.

Inspection and Repair:

If the VIN is within the specified range and included in the list beginning on *page 3*, inspect the light bar by removing the instrument cluster from the dashboard. If the part number of the light bar is A1441009-001, it does not need to be

replaced. Otherwise, perform the REPAIR PROCEDURE beginning on *page 5*.

Dealer Responsibility:

Dealers must perform this service program on affected vehicles at no charge to the owner regardless of vehicle mileage, age or ownership of the vehicle. If a vehicle affected by this service program is taken into or is in your vehicle inventory or at your dealership for service, you must perform this service program before the vehicle is sold or released to the owner.

Claims for Reimbursement:

Submit a claim following the instructions in the Claim Preparation section of the *Warranty Administration Manual*.

Claim Coding Information:

Authorization Number: SP 3-144-004

NOTE: Claims for reimbursement for this program will be paid by Autocar **ONLY** after the old light bar (identified as part number A1441001-001 or A1441004-001) is returned to the following address via FedEx ground account number 136769863:

Pacific Insight Electronics Corp.
1155 Insight Drive
Nelson, BC V1L 5P5
CANADA

Repair Number:

For ACX LH or RH drive with tilt steering or ACX dual drive:

For left hand light bar only	38139-1-00
For right hand light bar only	38139-1-01

For ACX LH or RH drive with fixed steering column:

For left hand light bar only	38139-1-03
For right hand light bar only	38139-1-04



Questions? Visit the Autocar website at www.autocartruck.com, and click the **Web-Link Direct** icon to request emergency service assistance.

SERVICE PROGRAM



SP 3-144-004

November, 2008

Expiration Date: 17 November 2009

Time Allowance:

For ACX LH or RH drive with tilt steering OR

ACX dual drive:

Left hand light bar only: 0.5 hrs.

Right hand light bar only: 0.5 hrs.

For ACX LH or RH drive with fixed

steering column:

Left hand light bar only: 0.9 hrs.

Right hand light bar only: 0.9 hrs.

Tools:

The following tools are required to perform this service program:

- Phillips Screw Driver
- Torque Wrench
- Ratchet
- 9/16" Socket
- 9/16" Wrench
- Phillips head bit

To order parts call: 765-489-6016

Parts:

<u>Part number and description</u>	<u>Quantity</u>
------------------------------------	-----------------

For ACX LH or RH drive:

A1441009-001 light bar	1
------------------------	---

For ACX dual drive:

A1441009-001 light bar	2
------------------------	---



Questions? Visit the Autocar website at www.autocartruck.com, and click the **Web-Link Direct** icon to request emergency service assistance.

SERVICE PROGRAM



SP 3-144-004

November, 2008

Affected Vehicles (by VIN):

Affected Vehicles, sorted by last (6) digits of VIN, in ascending order from left to right, then top to bottom:

5VCACLKH38H206686	5VCACLHE98H206687	5VCACLKF88H206732	5VCACLHE18H206733
5VCACLHE38H206734	5VCACLHE58H206735	5VCACLHE78H206736	5VCACLHE98H206737
5VCACLHE08H206738	5VCACLHE28H206739	5VCACRJFX8H206817	5VCACLKH18H206895
5VCACLJF78H206951	5VCACLJF58H207001	5VCACRJF68H207236	5VCACDJF08H207378
5VCACLKF18H207379	5VCACLKF88H207380	5VCACLKFX8H207381	5VCACLKF18H207382
5VCACLKF38H207383	5VCACLKF58H207384	5VCACLKF78H207385	5VCACLKF98H207386
5VCACLKF08H207387	5VCACLKF28H207388	5VCACLKF48H207389	5VCACLKF08H207390
5VCACLKF28H207391	5VCACLKF48H207392	5VCACLKF68H207393	5VCACLKF88H207394
5VCACLKFX8H207395	5VCACLKF18H207396	5VCACLKF38H207397	5VCACLKF58H207398
5VCACLJF38H207417	5VCACLHE38H207432	5VCACLHE58H207433	5VCACLHE78H207434
5VCACLHE98H207435	5VCACSK08H207438	5VCACSK28H207439	5VCACSK98H207440
5VCACSK08H207441	5VCACSK28H207442	5VCACRLE98H207445	5VCACRLE08H207446
5VCACRLE28H207447	5VCACRLE48H207448	5VCACRLE68H207449	5VCACRLE28H207450
5VCACRLE48H207451	5VCACRLE68H207452	5VCACRLE88H207453	5VCACRLEX8H207454
5VCACRLE18H207455	5VCACRLE38H207456	5VCACRLE58H207457	5VCACRLE78H207458
5VCACRLE98H207459	5VCACRLE58H207460	5VCACRLE78H207461	5VCACLKE98H207539
5VCACLKE58H207540	5VCACLKE78H207541	5VCACRLE78H207542	5VCACRLE98H207543
5VCACRLE08H207544	5VCACRLE28H207545	5VCACRLE48H207546	5VCACRLE68H207547
5VCACRLE88H207548	5VCACLHE58H207559	5VCACLHE18H207560	5VCACLLE58H207584
5VCACRLE38H207585	5VCACLHE79H207600	5VCACLHE99H207601	5VCACLHE09H207602
5VCACLHE29H207603	5VCACLHE49H207604	5VCACLHE69H207605	5VCACLHE89H207606
5VCACLHEX9H207638	5VCACLHE19H207639	5VCACLJF68H207640	5VCACLJF69H207641
5VCA3LJF98H207650	5VCACLJF69H207655	5VCACLKFX9H207656	5VCACLHE79H207659
5VCACLHE39H207660	5VCACLHE59H207661	5VCACLHE79H207662	5VCACLHE99H207663
5VCACLHE09H207664	5VCACLHE29H207665	5VCACLHE49H207666	5VCACLKF38H207674
5VCACLKF58H207675	5VCACLHE79H207676	5VCACLHE99H207677	5VCACLKF79H207694
5VCACLKF99H207695	5VCACLKF09H207696	5VCACLKF29H207697	5VCACDKF19H207700
5VCACDKF39H207701	5VCACLHE49H207702	5VCACLHE69H207703	5VCACLKH79H207745
5VCACRLE38H207750	5VCACRLE58H207751	5VCACRLE78H207752	5VCACRLE98H207753
5VCACLHE19H207754	5VCACLHE29H207763	5VCACLHE49H207778	5VCACLLEX9H207789
5VCACLLE69H207790	5VCACLLE89H207791	5VCACLLEX9H207792	5VCACLLE19H207793
5VCA3LHF99H207798	5VCACLKE09H207799	5VCACLKE39H207800	5VCACLKE59H207801
5VCACLKE79H207802	5VCACLKE99H207803	5VCACLKE09H207804	5VCACLKE29H207805
5VCACLLE59H207814	5VCACLLE79H207815	5VCACLLE99H207816	5VCACLKF89H207817
5VCACLKFX9H207818	5VCACLHE39H207819	5VCACLHEX9H207820	5VCACSKF49H207825
5VCACSKF69H207826	5VCACSKF89H207827	5VCACSKFX9H207828	5VCACSK29H207829
5VCACSK99H207830	5VCACLJF59H207842	5VCACLHE09H207843	5VCACLKF09H207844
5VCACLKF29H207845	5VCACLKF49H207846	5VCACLKF69H207847	5VCACLKF89H207848
5VCACLJF79H207857	5VCACLJF99H207858	5VCACLJF09H207859	5VCACLJF79H207860
5VCACLJF99H207861	5VCACLJF09H207862	5VCACLJF29H207863	5VCACLJF49H207864
5VCACLJF69H207865	5VCACLJF89H207866	5VCACLJFX9H207867	5VCACDKF79H207880
5VCACLKF69H207881	5VCACLKF89H207882	5VCACLKFX9H207883	5VCACLKF19H207884
5VCACLKF39H207885	5VCACLKF59H207886	5VCACLKF79H207887	5VCACLKF99H207888



Questions? Visit the Autocar website at www.autocartruck.com, and click the **Web-Link Direct** icon to request emergency service assistance.

SERVICE PROGRAM



SP 3-144-004

November, 2008

5VCACLKF09H207889	5VCACLKF79H207890	5VCACLHE09H207891	5VCACLHE29H207892
5VCACLKF09H207908	5VCACLKF29H207909	5VCACLKF99H207910	5VCA3RHE08H207911
5VCACSKE89H207916	5VCACSKE9H207917	5VCACSKE19H207918	5VCACSKE39H207919
5VCACSKE9H207920	5VCACSKE19H207921	5VCACLKE69H207922	5VCACSJF29H207923
5VCACLJF79H207924	5VCACLJF99H207925	5VCACLJF09H207926	5VCACLJF29H207927
5VCACLKF69H207928	5VCACLHE99H207968	5VCACLHE09H207969	5VCACLHE79H207970
5VCACLHE99H207971	5VCACLHE09H207972	5VCACRLE99H207995	5VCACRJF69H207996
5VCACLJF19H207997	5VCACLJF69H208031	5VCACLJF89H208032	5VCACLHE39H208033
5VCACLHE59H208034	5VCACRJF69H208050	5VCA3RJF89H208051	5VCA3RJFX9H208052
5VCA3RJF19H208053	5VCA3RJF39H208054	5VCACRJF59H208055	5VCACRJF79H208056
5VCACRJF99H208057	5VCACRJF09H208058	5VCACLHE19H208080	5VCACLKH59H208103
5VCACLKH79H208104	5VCACLHE29H208105	5VCACLHE49H208106	5VCACLJF59H208117
5VCACLKF99H208118	5VCACLKF09H208119	5VCACLKF79H208120	5VCACRKF59H208121
5VCACRKF79H208122	5VCACRKF99H208123	5VCACRHEX9H208128	5VCACRHE19H208129
5VCACLKFX9H208130	5VCACLKF19H208131	5VCACLKF39H208132	5VCACLKF59H208133
5VCACLKF79H208134	5VCACLKF99H208135	5VCACLKF09H208136	5VCACLKF29H208137
5VCACLKF49H208138	5VCACLKF69H208139	5VCACLKF29H208140	5VCACLJF49H208206
5VCACLJF69H208207	5VCACLJF89H208208	5VCACLJFX9H208209	5VCACLJF69H208210
5VCACDKF29H208211	5VCACLJF19H208213	5VCACLJF39H208214	5VCACLJF79H208216
5VCACLJF99H208217	5VCACLJF09H208218	5VCACLJF29H208219	5VCA3RKF79H208220
5VCACLJF29H208320	5VCACLJF49H208321	5VCACLJF69H208322	5VCACLJF89H208323
5VCACLJFX9H208324	5VCACLJF19H208325	5VCACLJF39H208326	5VCACRLE69H208327
5VCACRLE89H208328	5VCACRLEX9H208329	5VCACRLE69H208330	5VCACRLE89H208331
5VCACRLEX9H208332	5VCACRLE19H208333	5VCACRLE39H208334	5VCACLJF49H208335
5VCACLHE59H208342	5VCACLHE99H208361	5VCACLHE09H208362	5VCACLHE29H208363
5VCACLHE49H208364	5VCACLHE69H208365	5VCACLHE89H208366	5VCACLHEX9H208367
5VCACRJF49H208368	5VCACRJF69H208369	5VCACLKF09H208377	5VCACLHE39H208386
5VCACLLE89H208438	5VCACLHE99H208439	5VCACLLE69H208440	5VCACLLE89H208441
5VCACRJF19H208442	5VCACLJF79H208443	5VCACLHE29H208444	5VCACLHE49H208445
5VCACLKF49H208446	5VCACLJF49H208447	5VCACLJF69H208448	5VCACLJF89H208483
5VCACLJFX9H208484	5VCACLJF19H208485	5VCACLJF39H208486	5VCACLJF59H208487
5VCACLJF79H208488	5VCACRJF59H208489	5VCACRJF19H208490	5VCACRJF39H208491
5VCACRJF59H208492	5VCACLKF19H208498	5VCACLKF39H208499	5VCACLJF69H208501
5VCACLKF29H208512	5VCACLKF49H208513	5VCACLKF69H208514	5VCACLJF19H208518
5VCACLJF39H208519	5VCACLJFX9H208520	5VCACLLE69H208521	5VCACLLE89H208522
5VCACLLEX9H208523	5VCACLJF79H208524	5VCACLHE29H208525	5VCACLHE49H208526
5VCACLHE69H208527	5VCACLHE89H208528	5VCACLHEX9H208529	5VCACLHE39H208548
5VCACLKF69H208559			



Questions? Visit the Autocar website at www.autocartruck.com, and click the **Web-Link Direct** icon to request emergency service assistance.

SERVICE PROGRAM



SP 3-144-004

November, 2008

REPAIR PROCEDURE:



WARNING



To prevent eye injury, always wear eye protection when performing vehicle maintenance, service, or inspection.



WARNING



Turn and lock battery disconnect switch to disconnect the battery supply from the rest of the truck to limit the risk of fire when working on the truck



DANGER



Before working on a vehicle, turn the engine to off, set the parking brake, place the transmission in neutral and block the wheels. Failure to do so can result in unexpected vehicle movement, resulting in serious personal injury or death.

NOTE:

For ACX LH or RH drive with fixed steering column, begin at Step 1.

For ACX LH or RH drive with tilt steering or ACX dual drive, begin at Step 3.

1. Remove the (4) steering column bracket bolts holding the steering column in place. Use a 9/16" wrench, ratchet and 9/16" socket to remove the bolts. See Figure 1 showing steering column bracket bolt locations.



2. Rotate or lower the steering column to gain access to the instrument cluster screw blocked by the turn signal collar. See Figure 2 showing the screw covered by the turn signal collar.

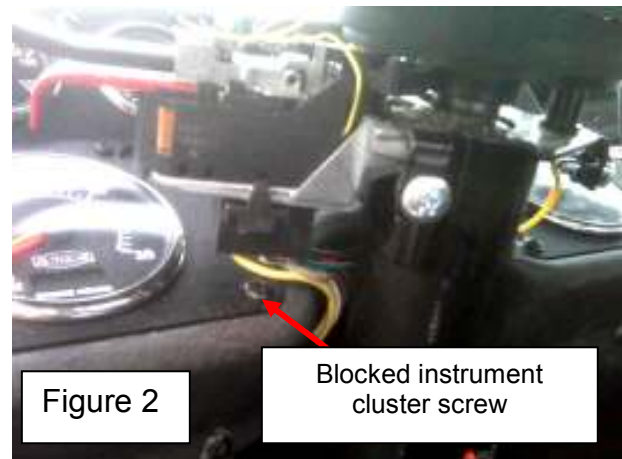

Questions? Visit the Autocar website at www.autocartruck.com, and click the **Web-Link Direct** icon to request emergency service assistance.

SP 3-144-004

November, 2008

3. Remove the instrument cluster from the dash by removing (8) screws with a ratchet or Phillips head screw driver (Figure 3).

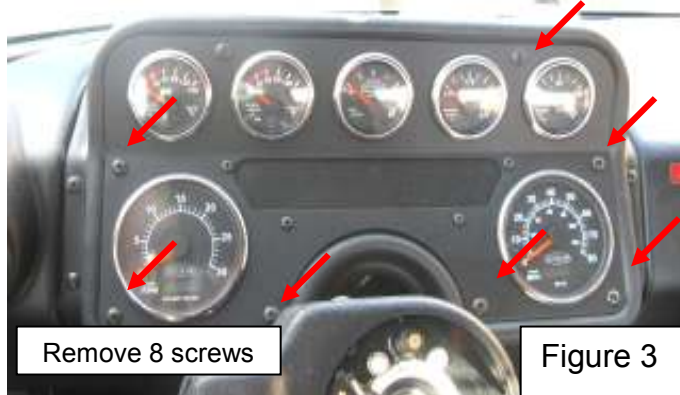

4. Pull the instrument cluster from the dash. Remove the (2) white harness connectors from back of the instrument cluster light bar. See Figure 4 for the light bar connectors to be removed.

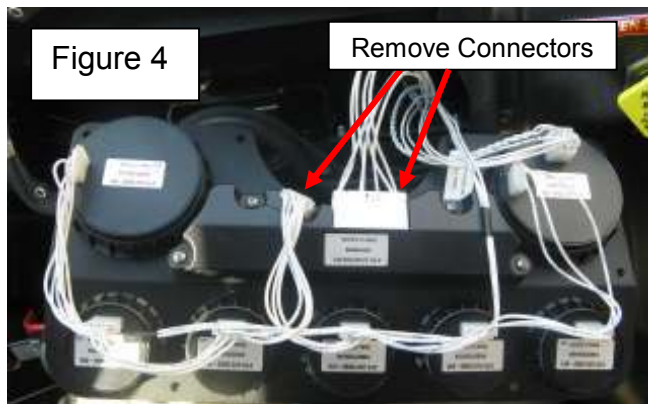

5. Remove the A1441001-001 or A1441004-001 light bar from the instrument cluster by removing the (4) screws with a ratchet or Phillips screwdriver. See Figure 5 showing the light bar screw locations.

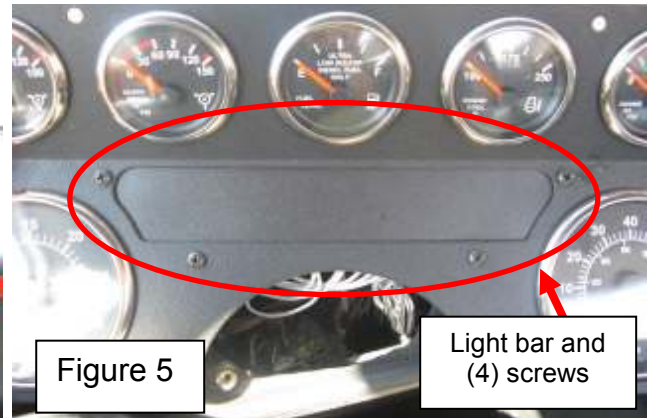

6. Install the A1441009-001 light bar to the instrument cluster with (4) screws and a Phillips screw driver.
7. Reinstall the (2) white harness connectors to the back side of the A1441009-001 light bar.
8. Reinstall the instrument cluster to the dash with (8) screws and a Phillips screw driver.
9. If the steering column bolts were removed, position the steering column back into the correct position and install the column bracket with (4) bolts.
10. Tighten the (4) steering column bracket bolts with a ratchet and 9/16" socket and torque the bolts to 30+/-3 Ft-lbs. with a torque wrench.
11. For an ACX dual-drive truck, move to the opposite side of the cab, and repeat Step 3 through Step 8 for the opposite side light bar.

